

29 PALMS HWY

29 PALMS
OUTERHIGHWAY

VICINITY MAP

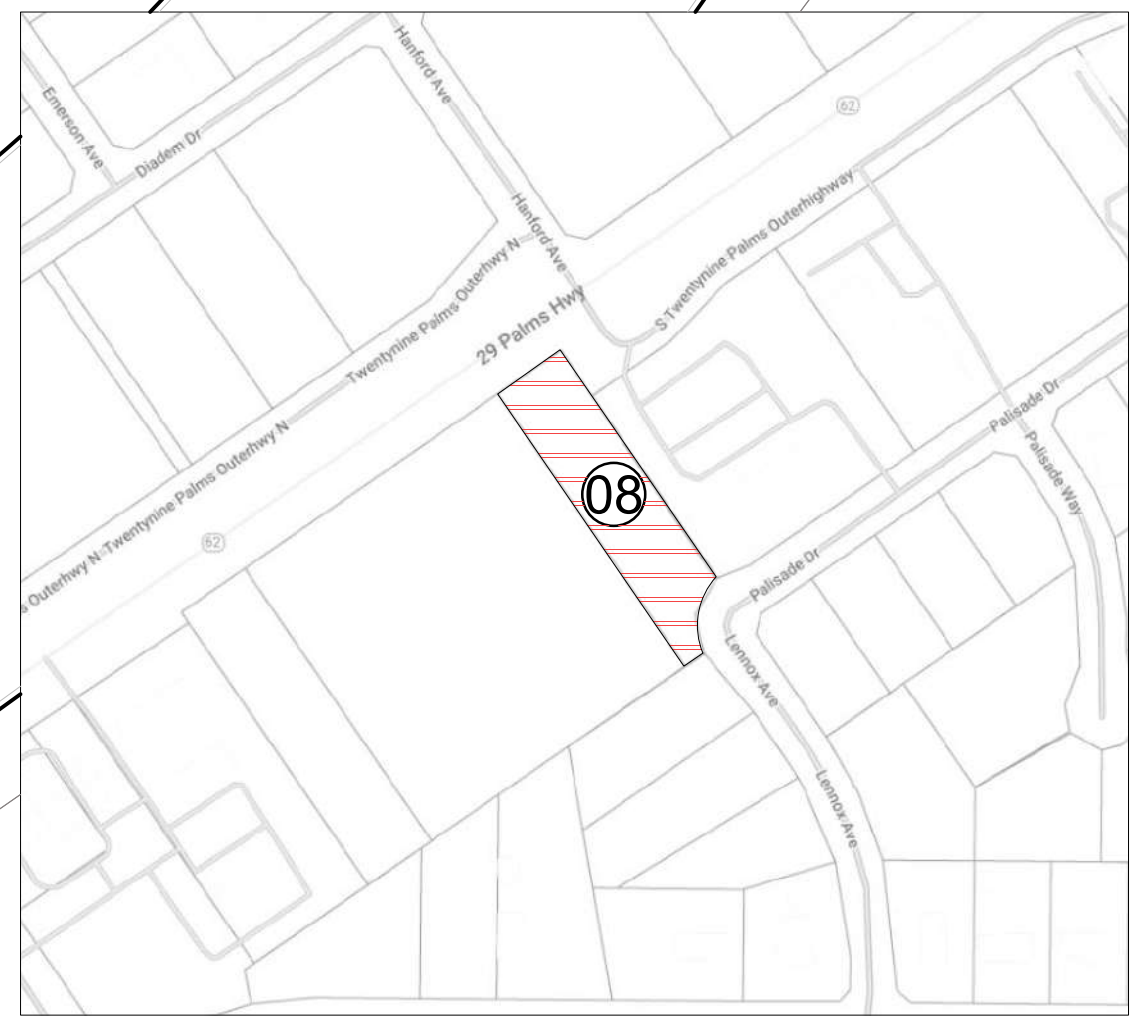

LEGEND

JOSHUA TREE



INDICATES PROPERTY BORDER

INDICATES EXISTING COUNTOURS

SIDEWALK



ACCESSIBLE ROUTE

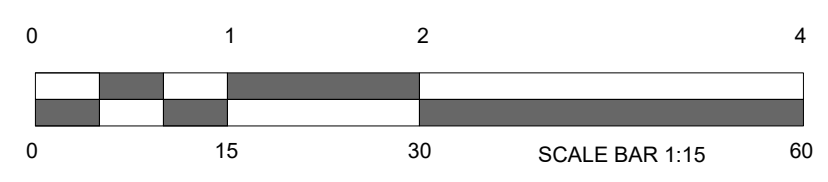

LOT 07 APN 0601-412-17-0000
COMMERCIAL
MEDICAL OFFICE

LEGAL

LOT 07 APN 0601-412-08-0000
ACCESSORS MAP Bk. 0601
SAN BERNARDINO COUNTY, CA

EXISTING AND PROPOSED DESIGNATION

C-G

EXISTING AND PROPOSED GENERAL PLAN DESIGNATION

GENERAL COMMERCIAL

SPECIFIC PLAN IDENTIFICATION AND LAND USE DESIGNATION

NOT APPLICABLE

EXISTING LAND USE

0601-412-08-0000: VACANT

PROPOSED LAND USE

0601-412-08-0000: WAREHOUSE RETAIL

Total gross area: - 1560 SQ. FT.

APPROXIMATE EARTHWORK QUANTITIES

Cut:

Fill:

UTILITY PROVIDERS

WATER
HIGH DESERT WATER DISTRICT
55439 Twentynine Palms Highway, Yucca Valley, CA
(760) 365-8333

ELECTRICITY
SOUTHERN CALIFORNIA EDISON
6999 Old Woman Springs Rd, Yucca Valley, CA 92284
(800) 655-4555

TELEPHONE
VERIZON CALIFORNIA
295 N Sunris Way, Palm Springs, CA 92262
(760) 778-3610

TV CABLE
TIME WARNER CABLE
73181 Mediterranean Rd, Palm Desert, CA 92211
(760) 674-5404

WASTE DISPOSAL
BURRTEC
4878 Newton Ln, Yucca Valley, CA 92284
(760) 365-2015

SEWAGE
SEPTIC SYSTEM OR PACKAGE WASTEWATER
TREATMENT PLANT

PARKING

13 - 9'X19' PARKING SPACES
1 - ACCESSIBLE SPACE
1 - LOADING SPACE

PROPERTY OWNER & APPLICANT

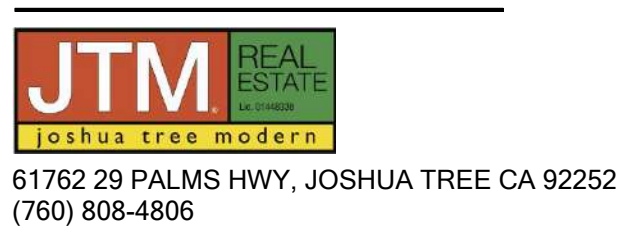

REPRESENTATIVE

MATTHEW ARCHER STEPHENSON
63177 GOLDEN ST, JOSHUA TREE, CA 92252
(442) 205-7932
archer@lamalkal.com

DESIGN AND DRAWINGS



TOWN OF YUCCA VALLEY

**PRELIMINARY SITE PLAN
YUCCA OFFICES**

SHEET
A101

LOT 07 APN 0601-412-09-0000
COMMERCIAL
VACANT LAND

PALISADE DR.