

PRELIMINARY UTILITY PLAN

55546 YUCCA TRAIL, YUCCA VALLEY, CA 92284

APN: 0594-041-22-0000

YUCCA TRAIL STORAGE

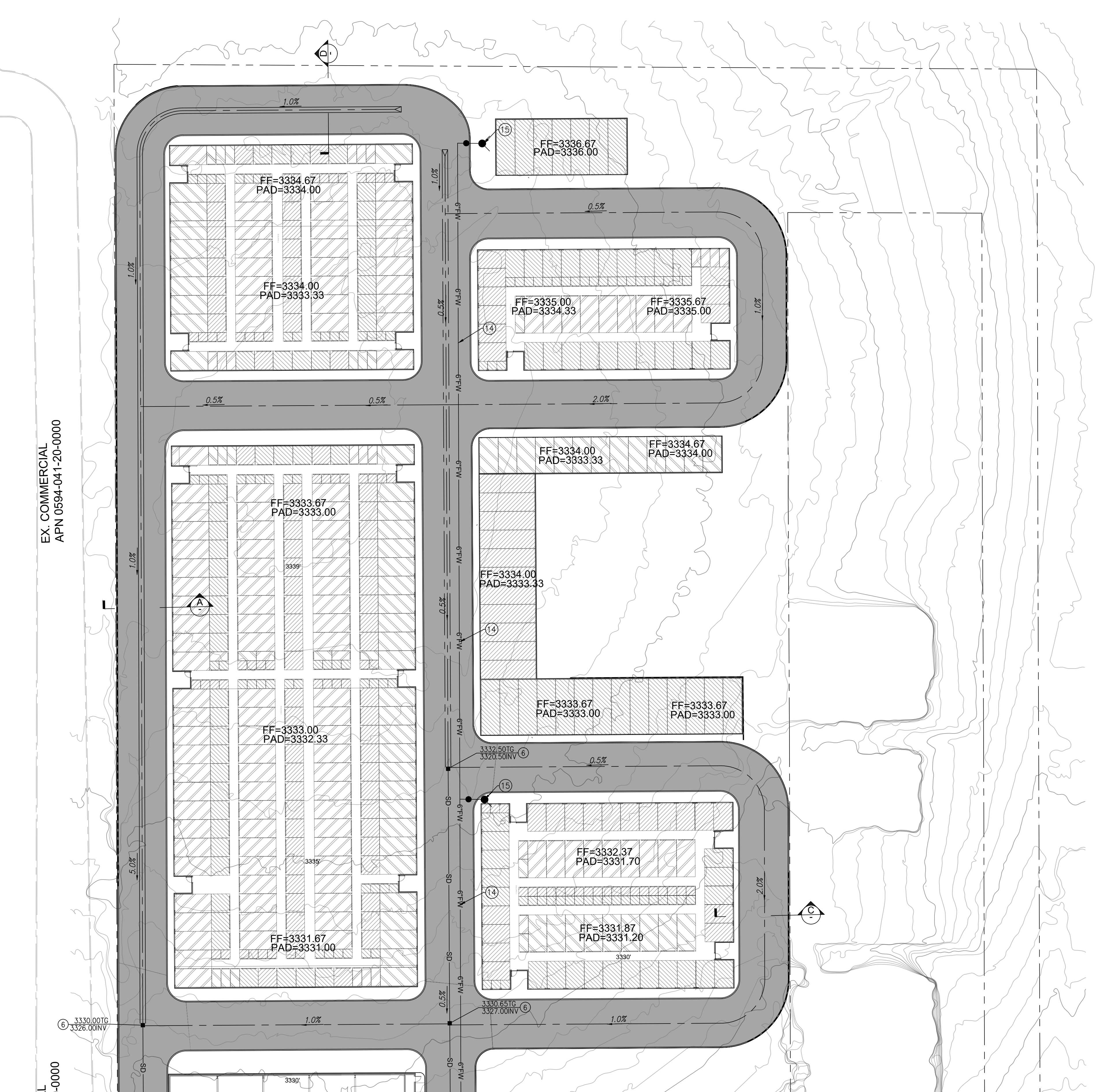

EX. COMMERCIAL
APN 0594-041-20-0000

LEGEND:

— — — — —	CENTERLINE	EP	EDGE OF PAVEMENT
— — — — —	PROPERTY LINE	FF	FINISHED FLOOR
— W — — —	WATER LINE	FG	FINISHED GROUND
— S — — —	SEWER LINE	FL	FLOW LINE
— — — — —	ELECTRIC LINE	FS	FINISHED SURFACE
— OHE — — —	GAS LINE	GB	GRADE BREAK
— GAS — — —	EXIST. CHAIN LINK FENCE	HP	HIGH POINT
— X — — —	EXIST. WOOD FENCE	INV	INVERT ELEVATION
— O — — —	EXIST. BLOCK WALL	PAD	PAD ELEVATION
— 944 — — —	EXIST. CONTOUR LINE	RET.	RETAINING WALL
— 945.0 — — —	EXIST. SPOT ELEVATION	TC	TOP OF CURB
— FS — — —	EXIST. FIRE HYDRANT	TG	TOP OF GRATE
— — — — —	EXIST. POWER POLE		
— — — — —	EXIST. SEWER MANHOLE		
— — — — —	EXIST. STORM DRAIN MANHOLE		
— — — — —	EXIST. WATER METER		
— — — — —	EXIST. WATER VALVE		
— — — — —	EXIST. TREE		
— — — — —	CONCRETE PAVING		
— — — — —	LANDSCAPING		
— — — — —	GRASSCRETE PAVERS OR SIMILAR		
— — — — —	WOOD BOARDWALK		
— — — — —	DECOMPOSED GRANITE		

UTILITY CONSTRUCTION NOTE:

- ⑧ PROPOSED 1" DOM SERVICE AND METER
- ⑨ PROPOSED SEPTIC TANK
- ⑩ PROPOSED LEACH FIELD
- ⑬ PROPOSED FIRE SERVICE - DCDA
- ⑭ PROPOSED FIRE SERVICE LINE 6"
- ⑮ PROPOSED FIRE HD LOCATION
- ⑯ PROPOSED ELEC. POWER POLE DROP

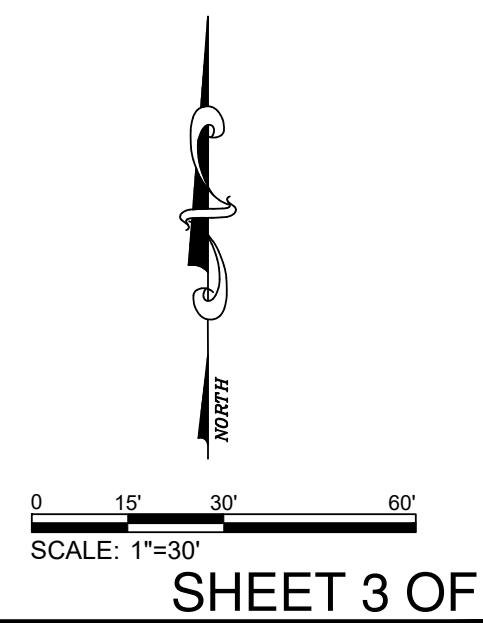

SHEET 3 OF 4

MATCHLINE SEE SHEET 4



DRP ENTERPRISES LLC
Daniel Patnequide
MAILING ADDRESS:
PO Box 4428
Palm Springs, CA 92263
206-734-7765
Joanne C. Singer RCE 26900
760-625-7426
DATE: 4/12/2024



PRELIMINARY UTILITY PLAN

55546 YUCCA TRAIL, YUCCA VALLEY, CA 92284

APN: 0594-041-22-0000

LEGEND:

---	CENTERLINE	EP	EDGE OF PAVEMENT
- - -	PROPERTY LINE	FF	FINISHED FLOOR
W	WATER LINE	FG	FINISHED FLOOR
S	SEWER LINE	FL	FLOW LINE
---	ELECTRIC LINE	FS	FINISHED SURFACE
---	GAS LINE	GB	GRADE BREAK
X	EXIST. CHAIN LINK FENCE	HP	HIGH POINT
○	EXIST. WOOD FENCE	INV	INVERT ELEVATION
█	EXIST. BLOCK WALL	PAD	PAD ELEVATION
944	EXIST. CONTOUR LINE	RET.	RETAINING WALL
945.0 FS	EXIST. SPOT ELEVATION	TC	TOP OF CURB
○	EXIST. FIRE HYDRANT	TG	TOP OF GRATE
●	EXIST. POWER POLE		
⊙	EXIST. SEWER MANHOLE		
⊕	EXIST. STORM DRAIN MANHOLE		
WM	EXIST. WATER METER		
⊗	EXIST. WATER VALVE		
⊕	EXIST. TREE		
▨	CONCRETE PAVING		
▨	LANDSCAPING		
▨	GRASSCRETE PAVERS OR SIMILAR		
▨	WOOD BOARDWALK		
▨	DECOMPOSED GRANITE		

UTILITY CONSTRUCTION NOTE:

- ⑧ PROPOSED 1" DOM SERVICE AND METER
- ⑨ PROPOSED SEPTIC TANK
- ⑩ PROPOSED LEACH FIELD
- ⑬ PROPOSED FIRE SERVICE - DCDA
- ⑭ PROPOSED FIRE SERVICE LINE 6"
- ⑮ PROPOSED FIRE HD LOCATION
- ⑯ PROPOSED ELEC. POWER POLE DROP

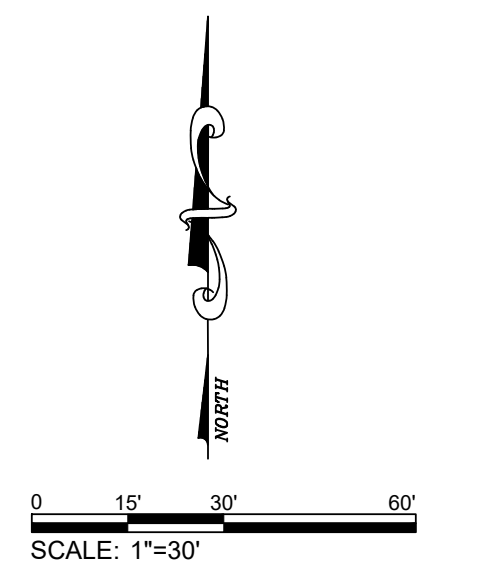
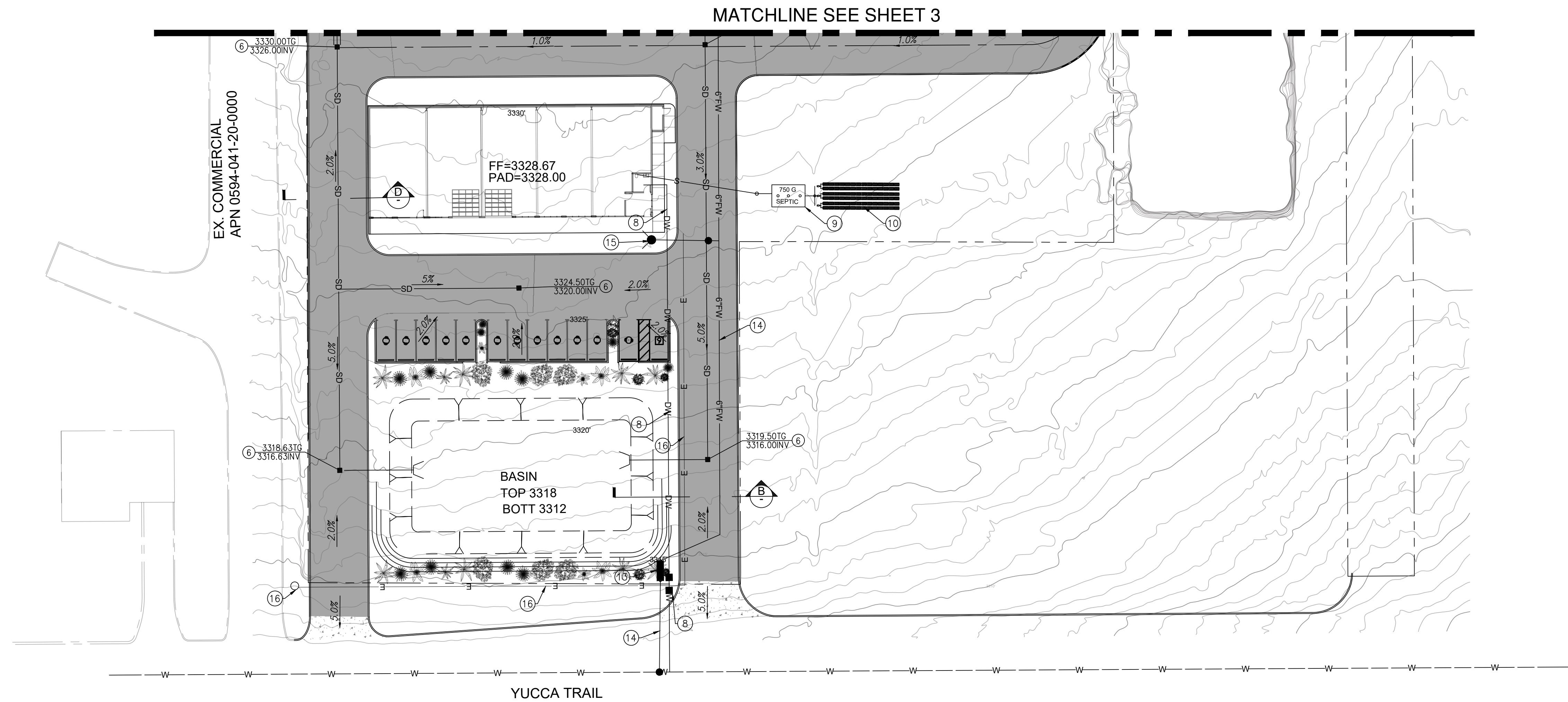

SHEET 4 OF 4



DRP ENTERPRISES LLC
 Daniel Patneoude
 MAILING ADDRESS:
 PO Box 4428
 Palm Springs, CA 92263
 206-734-7765
 Joanne C. Singer RCE 26900
 760-625-7426
 DATE: 3/23/2024

