

Designer  
**StudioDFD (Distillery for Design)**  
 56031 Sunnyslope Dr.  
 Yucca Valley, CA 92284  
 T: 818.422.3446

DEVELOPER  
**Liz Lapp, Stephen Lapp**  
 T: 415 713 5693

56695 Twentynine Palms Highway,  
 Yucca Valley CA 92284

The ideas and designs represented herein and this drawing, all prepared by StudioDFD are for the use solely with respect to this project and StudioDFD shall retain all common law, statutory and other reserved rights including copyright, and they shall not be used by others for any other purpose without written permission of StudioDFD.

Issue Dates  
 Issue Date

SHEET TITLE

ELECTRICAL PLAN

DATE: 09-01-22  
 SHEET NUMBER

E 101

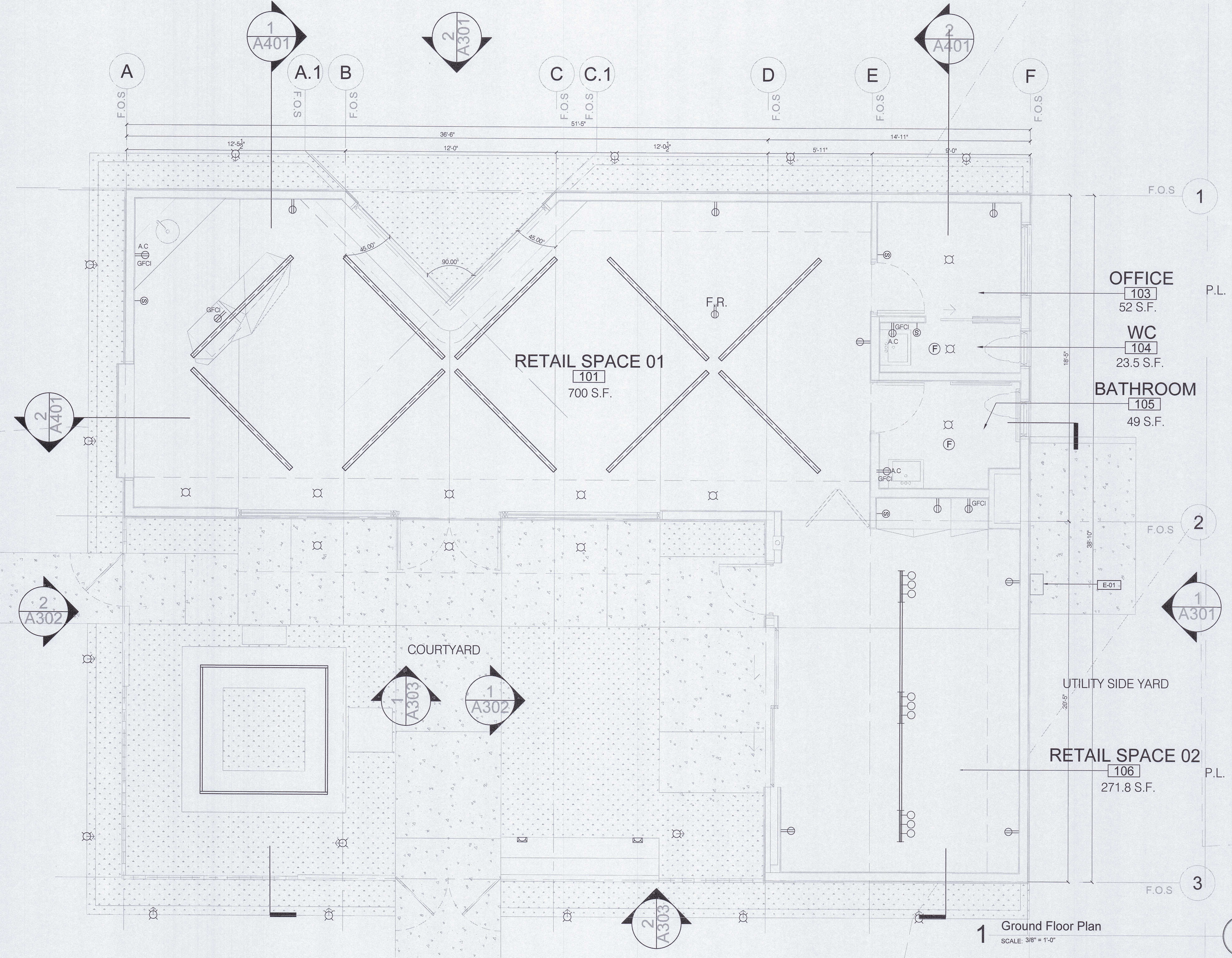

**1** Ground Floor Plan  
 SCALE: 3/8" = 1'-0"

- GENERAL NOTES**
- KEYNOTES ARE SPECIFIC TO THE DRAWING SECTION IN WHICH THEY RESIDE. ALPHABETICAL PREFIXES IDENTIFY DRAWING APPLICABILITY.
  - ALL EXTERIOR LIGHTING SHALL FOLLOW TOWN OF YUCCA VALLEY LIGHTING GUIDELINES.
  - DO NOT SCALE FROM DRAWINGS.
  - ANY INCONSISTENCIES OR UNFORESEEN CONDITIONS TO BE REVIEWED BY THE ARCHITECT PRIOR TO PROCEEDING WITH CONSTRUCTION.
  - GRID REFERENCES AND DIMENSIONS ARE INDICATED FOR REFERENCE ONLY. VERIFY ALL ACTUAL LOCATIONS IN THE FIELD.
  - SPOT ELEVATIONS NOTED ARE FOR REFERENCE ONLY AND ARE CONSISTENT ACROSS ENTIRE FLOOR PLATE UNLESS NOTED OTHERWISE. FIELD VERIFY EXISTING CONDITIONS AND NOTIFY ARCHITECT IN CASE OF DISCREPANCY.
  - COMPLY WITH ALL APPLICABLE LOCAL, STATE, AND FEDERAL CODES AND REGULATIONS PERTAINING TO SAFETY OF PERSONS, PROPERTY AND ENVIRONMENTAL PROTECTION.
  - HOSE BIBS TO BE INSTALLED PER PLUMBING DWGS.

- KEY NOTES**
- E-01 PROPOSED LOCATION FOR (200 AMP BREAKER PANEL)

- LEGEND**
- DOUBLE RECEPTACLE
  - GFCI DUPLEX RECEPTACLE
  - LIGHT SWITCH
  - PATHWAY LIGHTING
  - A.C. ABOVE COUNTER
  - F.R. FLOOR RECEPTACLE (2 GANG FLIP LID)
  - TRACK LIGHTS
  - DOWN LIGHT
  - IAQ FAN W HUMIDITY SENSOR
  - DIRECTIONAL LIGHTING (DARK SKY COMPLIANT)
  - LINEAR LED PENDANTS
  - CONCEALED LINEAR LED STRIP