

The ideas and designs represented herein and this drawing, all prepared by StudioDFD are for the use solely with respect to this project and StudioDFD shall retain all common law, statutory and other reserved rights including copyright, and they shall not be used by others for any other purpose without written permission of StudioDFD.

| Issue Dates | |
|-------------|------|
| Issue | Date |
| | |

SHEET TITLE

GROUND FLOOR PLAN

DATE: 09-01-22
 SHEET NUMBER

A 201

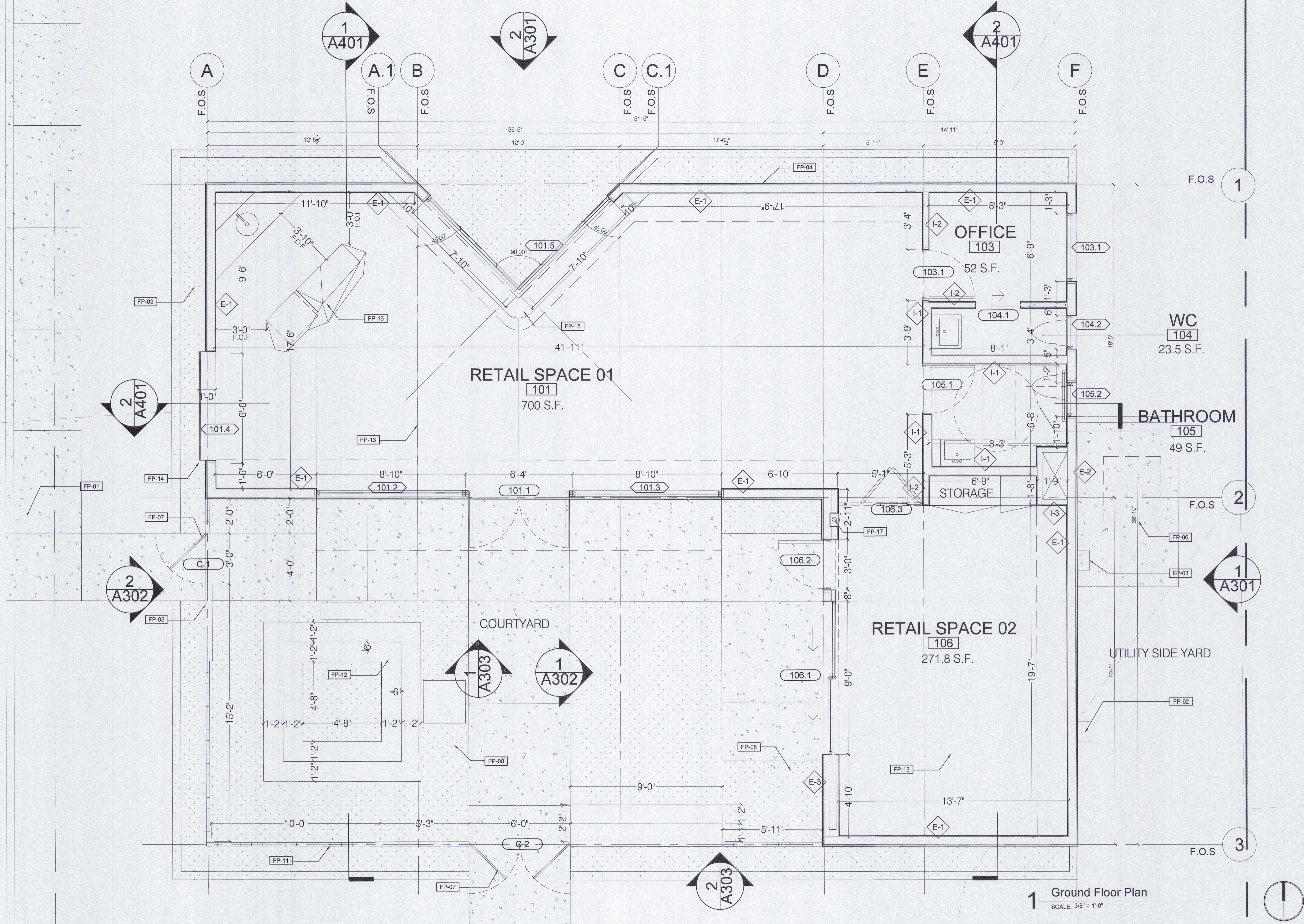

1 Ground Floor Plan
 SCALE: 3/8" = 1'-0"

GENERAL NOTES

- KEYNOTES ARE SPECIFIC TO THE DRAWING SECTION IN WHICH THEY RESIDE. ALPHABETICAL PREFIXES IDENTIFY DRAWING APPLICABILITY.
- ALL DIMENSIONS ARE TO FACE OF STUD (F.O.S.), UNLESS OTHERWISE NOTED.
- DO NOT SCALE FROM DRAWINGS.
- ANY INCONSISTENCIES OR UNFORESEEN CONDITIONS TO BE REVIEWED BY THE ARCHITECT PRIOR TO PROCEEDING WITH CONSTRUCTION.
- GRID REFERENCES AND DIMENSIONS ARE INDICATED FOR REFERENCE ONLY. VERIFY ALL ACTUAL LOCATIONS IN THE FIELD.
- SPOT ELEVATIONS NOTED ARE FOR REFERENCE ONLY AND ARE CONSISTENT ACROSS ENTIRE FLOOR PLAN UNLESS NOTED OTHERWISE. FIELD VERIFY EXISTING CONDITIONS AND NOTIFY ARCHITECT IN CASE OF DISCREPANCY.
- COMPLY WITH ALL APPLICABLE LOCAL, STATE, AND FEDERAL CODES AND REGULATIONS PERTAINING TO SAFETY OF PERSONS, PROPERTY AND ENVIRONMENTAL PROTECTION.
- HOSE BIBS TO BE INSTALLED PER PLUMBING & LANDSCAPE DWGS.

KEY NOTES

- FP-01 CONC. SIDEWALK PER COUNTY OF SAN BERNARDINO REQ'S
- FP-02 PROPOSED LOCATION FOR WATER METER
- FP-03 PROPOSED LOCATION FOR ELECTRICAL METER (200 AMP)
- FP-04 PROPOSED LOCATION FOR BUILDING SIGNAGE
- FP-05 BUILDING ADDRESS LOCATION (BLACK METAL LETTERING MIN 4" TALL)
- FP-06 PROPOSED LOCATION FOR MECHANICAL UNIT

KEY NOTES

- FP-07 PEDESTRIAN GATE
- FP-08 PEBBLE COURSE WITH XERISCAPING
- FP-09 BIO RETENTION AREAS. REFER TO CIVIL DWGS.
- FP-10 CONCRETE BENCHES
- FP-11 BREEZEWAY BLOCK WALL ON CONCRETE FOOTING
- FP-12 POLISHED CONCRETE (REFER TO FINISH SCHEDULE)

LEGEND

- FP-13 CONCRETE SAW CUT (1/2" WIDTH)
- FP-14 METAL PLATE POP OUT WINDOW (REFER TO WINDOW SCHEDULE)
- FP-15 BUILT-IN WOODEN BENCH SEATING
- FP-16 BUILT-IN WOODEN CASHIER'S DESK
- FP-17 RECESSED FIRE EXTINGUISHER CABINET (MODEL:128 EL)

LEGEND

- CONCRETE PAVING (SLOPE TO DRAIN. REFER TO CIVIL DWGS)
- BIORETENTION AREAS (REFER TO CIVIL DWGS.)
- XERISCAPING AREAS (REFER TO CIVIL DWGS.)
- PARKING STRIPING