

Drawing name: K:\RV_DEV\192236001_Dominoes\Yucca Valley\CADD\Exhibits\CUP_Submittal\C1.0 - Prelim Site Plan.dwg Sheet Jun 24, 2020 9:39am by: Umar-Khan

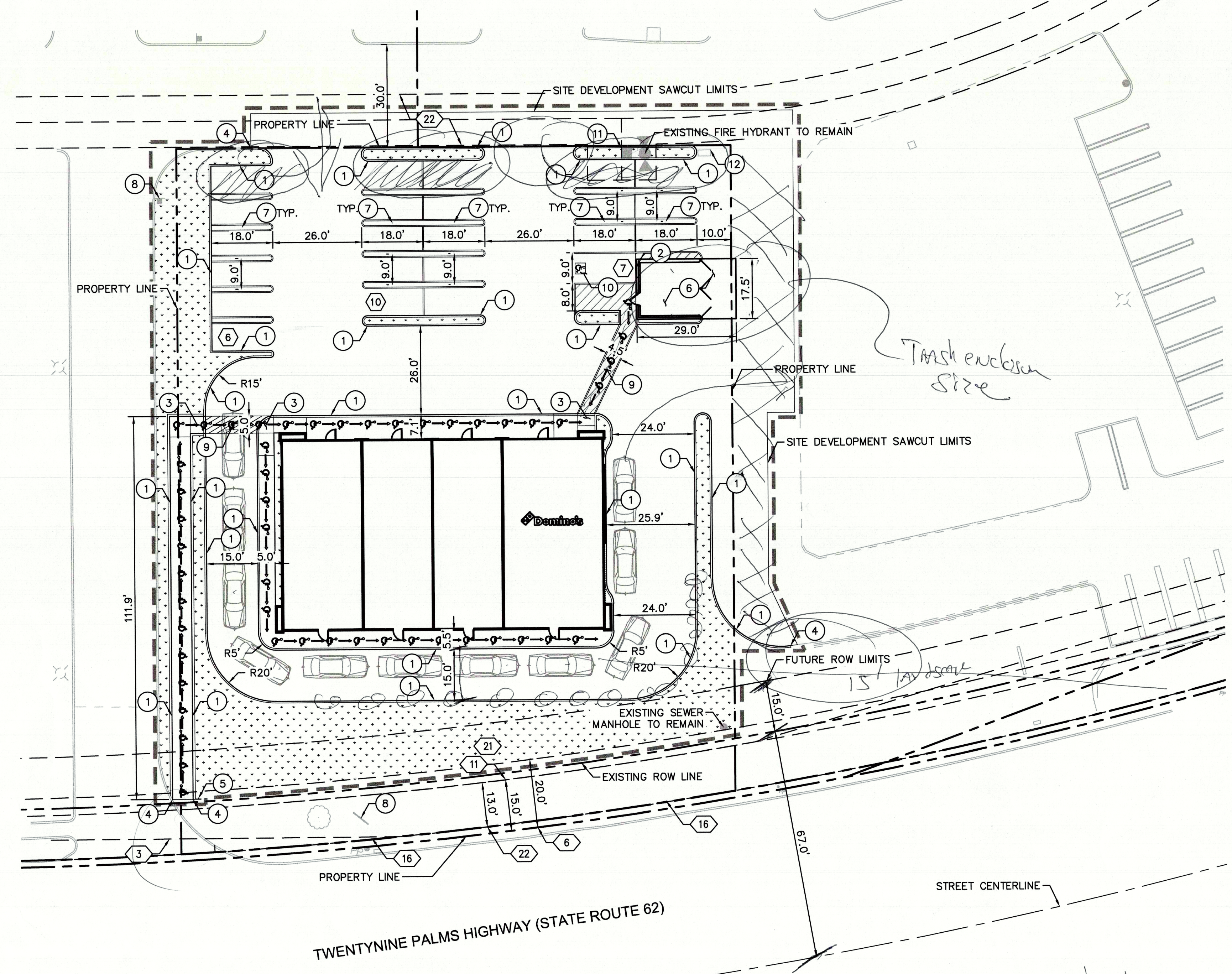

- 1) Scale car lengths for stack drive array
 - 2) Document easement granted on east side for irrigation
 - 3) mandatory exit through adjacent property?
 - 4) Check Drive thru standards for width - doublet have to meet center line min of 20' in width
 - 5) Do they show sag? dedicated sidewalks 60' 1/2 wide - double check labels
 - 6) Document ADA access from public street - SR62
 - 7) Materials Bonic
 - 8) (done) Elevation
- stack have screws

CONSTRUCTION NOTES:

- 1 CONCRETE CURB
- 2 ACCESSIBLE PARKING STALL SIGN
- 3 ACCESSIBLE RAMP WITH DETECTABLE WARNING (TRUNCATED DOMES)
- 4 JOIN EXISTING CURB, CURB & GUTTER, SIDEWALK.
- 5 ADA PATH OF TRAVEL SIGN
- 6 COVERED TRASH ENCLOSURE AND RECYCLING BIN STORAGE
- 7 STANDARD 90° PARKING STALL STRIPING.
- 8 EXISTING SIGN TO REMAIN
- 9 ACCESSIBLE PATH OF TRAVEL STRIPING. ACCESSIBLE PATHS SHALL BE ENHANCED PAVING.
- 10 ACCESSIBLE PARKING STRIPING.
- 11 EXISTING WATER METER BOX TO REMAIN.
- 12 EXISTING ELECTRICAL PULL BOX TO REMAIN.

TITLE REPORT EXCEPTIONS

- 3 AN EASEMENT AND RIGHT OF WAY TO THE UNITED STATES OF AMERICA FOR ELECTRICAL POWER TRANSMISSION LINES AND A SERVICE ROAD FOR MILITARY PURPOSES OVER AND ACROSS SAID LAND, AS SET OUT IN NOTICE OF LIS PENDENS, RECORDED OCTOBER 03, 1952, IN BOOK 3032, PAGE 128, OFFICIAL RECORDS, AND ALSO SET OUT IN AMENDED NOTICE OF LIS PENDENS, RECORDED NOVEMBER 25, 1955, IN BOOK 3798, PAGE 1, OFFICIAL RECORDS, GIVING NOTICE OF AN ACTION IN THE UNITED STATES DISTRICT COURT, SOUTHER DISTRICT OF CALIFORNIA, CENTRAL DIVISION, CASE NO. 14528NW, CIVIL AND FURTHER OUTLINED TO ELECTRIC POWER COMPANY BY DOCUMENT RECORDED IN BOOK 5702, PAGE 300, OFFICIAL RECORDS.
- 6 AN EASEMENT FOR EITHER OR BOTH PIPE LINES, CONDUITS AND INCIDENTAL PURPOSES, RECORDED JUNE 03, 1963 AS BOOK 5921, PAGE 148 OF OFFICIAL RECORDS IN FAVOR OF: SOUTHERN CALIFORNIA GAS COMPANY, A CORPORATION, ITS SUCCESSORS AND ASSIGNS AFFECTS: AS DESCRIBED THEREIN
- 7 AN EASEMENT FOR GAS PIPE LINE AND INCIDENTAL PURPOSES, RECORDED JUNE 20, 1963 AS BOOK 5932, PAGE 945 OF OFFICIAL RECORDS. IN FAVOR OF: SOUTHERN CALIFORNIA GAS COMPANY, A CORPORATION, ITS SUCCESSORS AND ASSIGNS AFFECTS: AS DESCRIBED THERE IN
- 8 AN EASEMENT FOR PIPE LINES AND INCIDENTAL PURPOSES, RECORDED JULY 19, 1963 AS BOOK 5951, PAGE 979 OF OFFICIAL RECORDS. IN FAVOR OF: SOUTHERN CALIFORNIA GAS COMPANY, A CORPORATION, ITS SUCCESSORS AND ASSIGNS AFFECTS: AS DESCRIBED THERE IN
- 9 AN EASEMENT FOR PIPE LINES AND INCIDENTAL PURPOSES, RECORDED JULY 25, 1963 AS BOOK 5955, PAGE 474 OF OFFICIAL RECORDS. IN FAVOR OF: SOUTHERN CALIFORNIA GAS COMPANY, A CORPORATION, ITS SUCCESSORS AND ASSIGNS AFFECTS: AS DESCRIBED THERE IN
- 10 AN EASEMENT FOR PIPE LINES AND INCIDENTAL PURPOSES, RECORDED DECEMBER 12, 1963 AS BOOK 6047, PAGE 67 OF OFFICIAL RECORDS. IN FAVOR OF: SOUTHERN CALIFORNIA GAS COMPANY, A CORPORATION, ITS SUCCESSORS AND ASSIGNS AFFECTS: AS DESCRIBED THERE IN
- 11 AN EASEMENT FOR PIPE LINES AND INCIDENTAL PURPOSES, RECORDED FEBRUARY 05, 1975 AS BOOK 8610, PAGE 25 OF OFFICIAL RECORDS. IN FAVOR OF: SOUTHERN CALIFORNIA GAS COMPANY, A CORPORATION, ITS SUCCESSORS AND ASSIGNS AFFECTS: AS DESCRIBED THERE IN
- 16 ABUTTER'S RIGHTS OF INGRESS AND EGRESS TO OR FROM TWENTYNINE PALMS HIGHWAY, HAVE BEEN DEDICATED OR RELINQUISHED ON THE MAP OF PARCEL MAP NO. 14239 ON FILE IN BOOK 166, PAGE 70-73, OF PARCEL MAPS.
- 21 AN EASEMENT FOR PUBLIC UTILITIES AND INCIDENTAL PURPOSES, RECORDED OCTOBER 28, 1992 AS INSTRUMENT NO. 92-447605 OF OFFICIAL RECORDS. IN FAVOR OF: SOUTHERN CALIFORNIA EDISON COMPANY, A CORPORATION, ITS SUCCESSOR AND ASSIGNS AFFECTS: AS DESCRIBED THEREIN THE LOCATION OF THE EASEMENT CANNOT BE DETERMINED FROM RECORD INFORMATION.
- 22 AN EASEMENT FOR PUBLIC UTILITIES AND INCIDENTAL PURPOSES, RECORDED MATCH 03, 1993 AS INSTRUMENT NO. 93-099511 OF OFFICIAL RECORDS. IN FAVOR OF: SOUTHERN CALIFORNIA EDISON COMPANY, A CALIFORNIA CORPORATION, ITS SUCCESSORS AND ASSIGNS AFFECTS: AS DESCRIBED THEREIN
- 23 AN EASEMENT FOR PIPELINE, INGRESS AND EGRESS AND INCIDENTAL PURPOSES, RECORDED MARCH 10, 1993 AS INSTRUMENT NO. 93-108991 OF OFFICIAL RECORDS. IN FAVOR OF: HI-DESERT WATER DISTRICT AFFECTS: AS DESCRIBED THEREIN

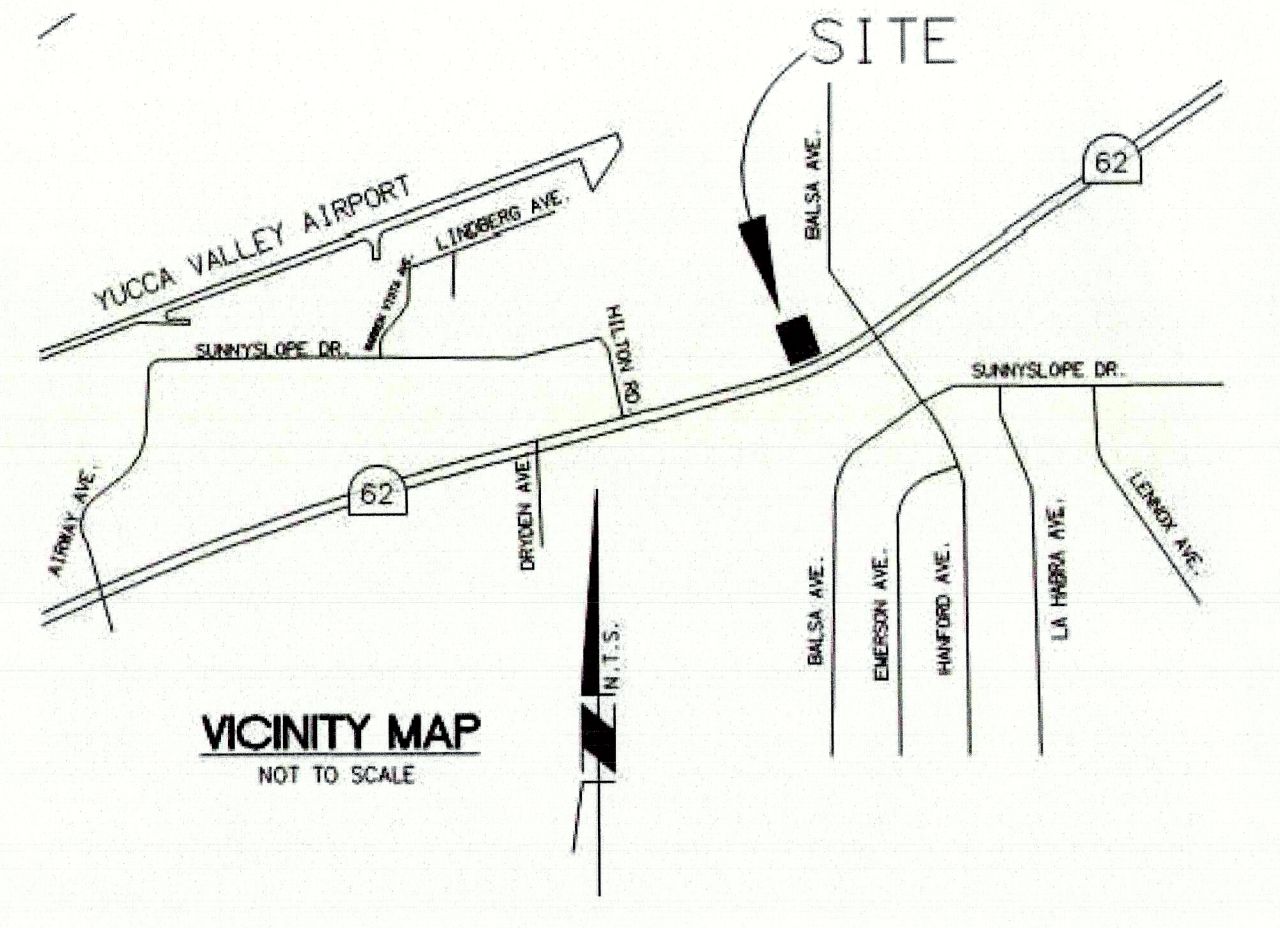

LEGEND:

- CENTER LINE
- - - PROPERTY LINE
- - - RIGHT-OF-WAY LINE
- - - EASEMENT LINE / SETBACK LINE
- - - APPROXIMATE LIMIT OF WORK LINE
- [Pattern] LANDSCAPE/PLANTER AREA
- [Symbol] ACCESSIBLE ROUTE (LOCATION PURPOSES ONLY, DO NOT PAINT)
- [Symbol] SIGN POST
- [Symbol] ACCESSIBLE PARKING SPACE
- [Symbol] NUMBER OF PARKING SPACES

LEGAL DESCRIPTION

PARCEL 6 OF PARCEL MAP NO. 14239, PMB 166/70-73

BASIS OF BEARINGS

BEARING SHOWN HEREON ARE BASED ON THE NORTHERLY LINE OF PARCEL 6 OF PARCEL MAP NO. 14629 AS SHOWN BY A MAP ON FILE IN BOOK 166 OF PARCEL MAPS, PAGES 70 THROUGH 73 INCLUSIVE, RECORDS OF THE COUNTY OF SAN BERNARDINO, STATE OF CALIFORNIA, BEING: NORTH 75°46'54" EAST

BENCHMARK

ELEVATION: 3226.50
 DATUM: NVD29
 LOCATION: TOP OF CURB AT ECR OF EAST DRIVEWAY CURB RETURN WITH STATION 155+34.21 BCR TWENTY-NINE PALMS HIGHWAY (STATE ROUTE 62), AS SHOWN ON STREET IMPROVEMENT PLANS FOR PARCEL MAP 14239 ON FILE IN THE OFFICE OF THE TOWN ENGINEER FOR THE TOWN OF YUCCA VALLEY, COUNTY OF SAN BERNARDINO, STATE OF CALIFORNIA.

Circle to illustrate on the site plan

Parking is 18'x9' - most be 19'x9'

underground utilities on site retention

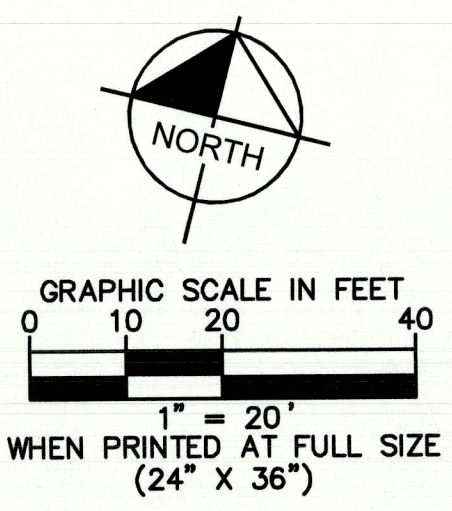

ISSUE	DATE	DESCRIPTION

DM
 DRAWN BY
 LT
 CHECKED BY
 SA
 RECOMMENDED



Kimley»Horn
 3880 LEMON STREET, SUITE 420
 RIVERSIDE, CA 92501
 (951) 543-9988
 PREPARED UNDER THE DIRECT SUPERVISION OF:
 DATE: 06/24/2020
 SHEA-MICHAEL ANTI, R.C.E. NO. 78274

CITY OF YUCCA VALLEY
 APPROVED BY:
 CITY ENGINEER
 RCE # _____ EXP _____ DATE _____

Domino's
 TWENTYNINE PALMS HWY & BALSA AVE
 YUCCA VALLEY, CA 92284

CITY OF YUCCA VALLEY
PRELIMINARY SITE PLAN

C1.0