

E:\Design\Work\Projects\Wine and Rocks\Floor Plans\DWG\2021\2021-08-20-1759.dwg

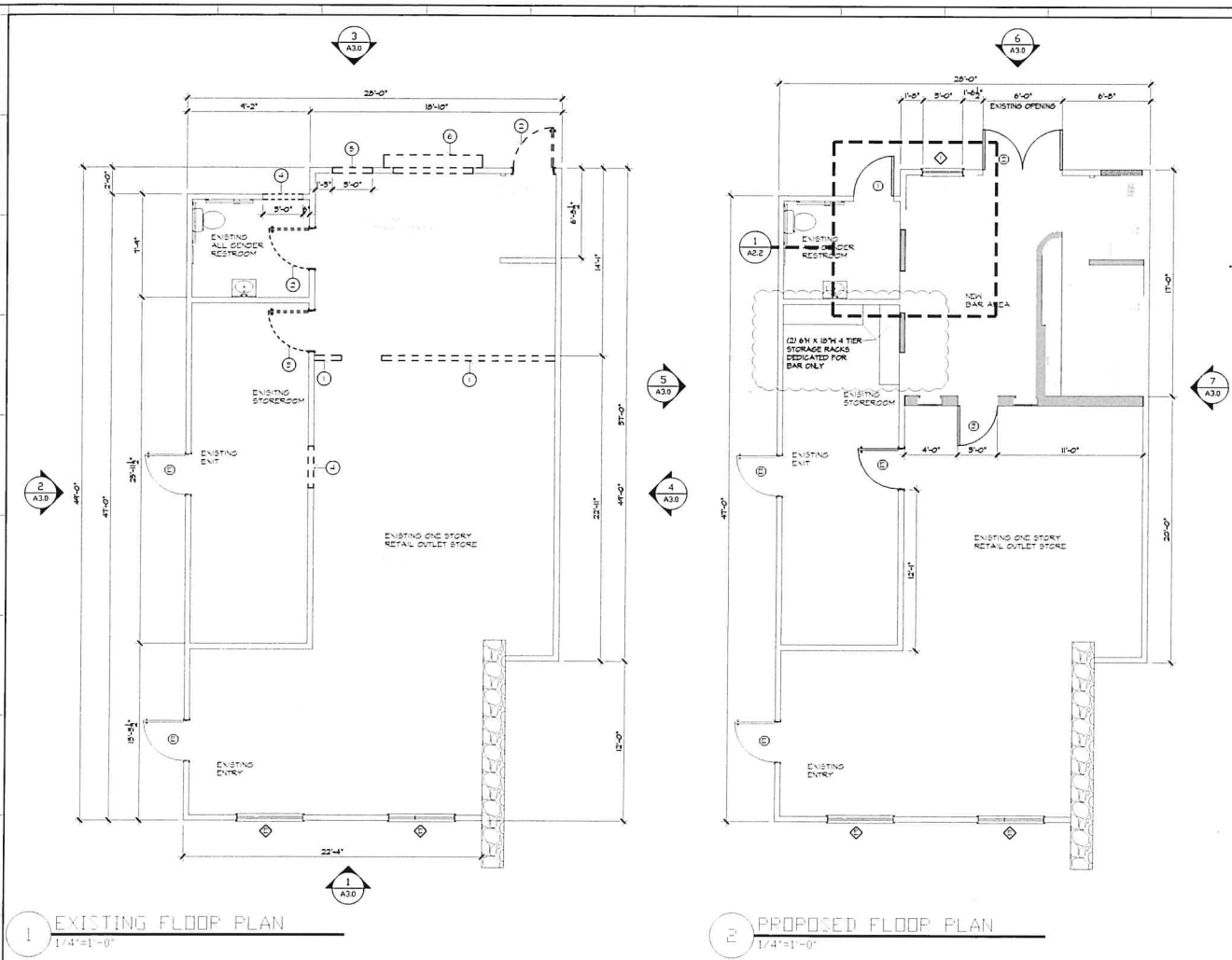

WINDOW SCHEDULE

SIZE (W x H)	TYPE	MATL	U-FACTOR	SHGC	FINISH	SCREEN
6" DIA	FIXED	VINYL	-	-	TED	NO

- GLAZING IS FINED UNLESS NOTED
- ALL GLAZING SHOULD BE EQUAL INSULATING GLASS
- ALL NEW GLAZING (PENETRATIONS) WILL BE INSTALLED WITH A CERTIFYING LABEL ATTACHED SHOWING THE U-VALUE
- GLAZING MARKED WITH "TEMPERED" SHALL BE 3/4" THICK TEMPERED GLASS
- THE MANUFACTURED WINDOWS SHALL HAVE A LABEL ATTACHED CERTIFIED BY THE NATIONAL FIRE PROTECTION RATING GROUP (NFPA) AND SHOWING COMPLIANCE WITH THE ENERGY CALCULATIONS
- ALL GLAZING IN HAZARDOUS LOCATIONS MUST BE IDENTIFIED BY A LABEL (PERMANENT IF TEMPERED) AS SAFETY GLAZING (SIF OR CASI)
- ALL WINDOW SOLAR TUBE LABELS TO REMAIN ON WINDOWS UNTIL AFTER FINAL INSPECTION
- ALL WINDOWS TO MEET ALL APPROVED TITLE 24 ALLOCATIONS
- TEMPERED OR LAMINATED SAFETY GLASS OR PLASTIC ENCLOSURE AT SHOWER OR TUB GLAZING IN ANY PORTION OF A BUILDING WALL ENCLOSED SHOWERS OR TUBS WHERE THE BOTTOM EDGE OF THE GLAZING IS LESS THAN 60" ABOVE STANDING SURFACE OR DRAIN INLET SHALL COMPLY.

DOOR SCHEDULE

SIZE (W x H)	THICK.	LOCATION	MATERIAL	REMARKS
5' x 6'-8"	1-3/4"	RESTROOM	VINYL	FINISH AND STYLE TBD
6' x 6'-8"	1-3/8"	REAR BAR	VINYL	FINISH DOOR A TEMP GLASS
2' x 6'-8"	1-3/8"	ENTRY BAR	WOOD	FINISH AND STYLE TBD

- 1 1/2" THICK SOLID CORE DOOR WITH A SELF-CLOSER AT SEPARATION OF HALL BETWEEN GARAGE AND DWELLING
- DOORS MAY OPEN INTO THE GARAGE ONLY IF THE FLOOR OR LANDING IN THE GARAGE IS NOT MORE THAN 1/2" LOWER THAN THE DOOR THRESHOLD
- THE LANDING OR FLOOR ON THE EXTERIOR SIDE SHALL NOT BE MORE THAN 1/2" BELOW THE TOP OF THE THRESHOLD RISE/STEP THE DOOR DOES NOT STAND OVER THE LANDING OR FLOOR AREA
- LANDING OF DOORS OTHER THAN THE REQUIRED CROSS DOOR SHALL NOT BE MORE THAN 1/2" BELOW THE TOP OF THE THRESHOLD RISE/STEP
- THRESH SHALL BE A LANDING OR FLOOR ON EACH SIDE OF EACH EXTERIOR DOOR LANDING SHALL HAVE A WIDTH NOT LESS THAN THE WIDTH OF THE DOOR AND BE A MINIMUM OF 24" IN LENGTH IN THE DIRECTION OF TRAVEL SLOPE OF EXTERIOR LANDING NOT TO EXCEED 1/4" FEET ON SLOPE OR 8:1
- SAFETY GLAZING SHALL BE INSTALLED IN THE FOLLOWING LOCATIONS:
 - WHERE THE GLAZING IS WITHIN 24 INCHES OF EITHER SIDE OF THE DOOR IN THE PLANE OF THE DOOR IN A CLOSED POSITION EXCEPT WHERE THERE IS AN INTERVENING WALL BETWEEN THE DOOR AND THE GLAZING
 - GLAZING IN SWINGING AND SLIDING DOORS
- FOR NON-FIRE-RATED DWELLINGS OPENINGS BETWEEN THE GARAGE AND RESIDENCE SHALL BE PROTECTED BY A 1-1/2" HIGH SELF-CLOSING SELF-LATCHING SOLID CORE DOOR OR A SELF-CLOSING AUTOMATIC-CLOSING AND SELF-LATCHING DOOR HAVING A FIRE-PROTECTION RATING OF NOT LESS THAN 20 MINUTES. THIS DOOR WILL BE FOR DOOR #4

WALL LEGEND

- 2 1/4" EXTERIOR STUO WALL @ 16" O.C. WITH 5-1/2" INSULATION & GYP. BD. @ INTERIOR @ COATS STUOCD OVER LATH & PAPER @ EXTERIOR OF WALL
- 2 1/4" INTERIOR STUO WALL @ 16" O.C. WITH 1/2" GYP. BD. ON BOTH SIDES
- EXISTING 2 1/4" WALLS TO REMAIN

CITY STAMPED

KEYNOTES

- EXISTING 8" HIGH NON-BEARING INTERIOR WALL
- EXISTING DOOR TO BE REMOVED. DOOR OPENING TO BE FRAMED FINISH TO MATCH EXISTING WALL
- EXISTING DOOR TO BE REMOVED AND RELOCATED
- EXISTING PORTION OF WALL TO BE REMOVED FOR NEW 6" DIA FINED GLASS
- EXISTING KILL-UP DOOR TO BE REMOVED.

PROJECT FILE: WINE AND ROCKS
59006 TWENTY NINE PALMS HIGHWAY
YUCCA VALLEY, CA 92284

NO.	DATE	REVISIONS
1	7.12.2021	

PROJECT TEAM: _____
DRAWING NUMBER: **A2.0**

FLOOR PLANS
ROCKE PARTNERS
PHONE (760) 848-4603
EMAIL DESIGND@NDRS@GMAIL.COM